



We are delighted to offer for sale 17 acres of land within one of the most sought after locations in North Down between Helen's Bay and Crawfordsburn. An area well known for its quality housing, convenience to the coast and popular amenities all at hand. The site could be used for a wide variety of future uses subject to planning.

- 17 Acres of Land in one of the most Sought After Areas of North Down between Helen's Bay and Crawfordsburn

Location:

Between Helen's Bay and Crawfordsburn.

Offers Around  
£400,000

17 Acres @ Bridge Road,  
Crawfordsburn,  
BT19

---

Viewing by  
appointment  
through agent  
028 9042 4747

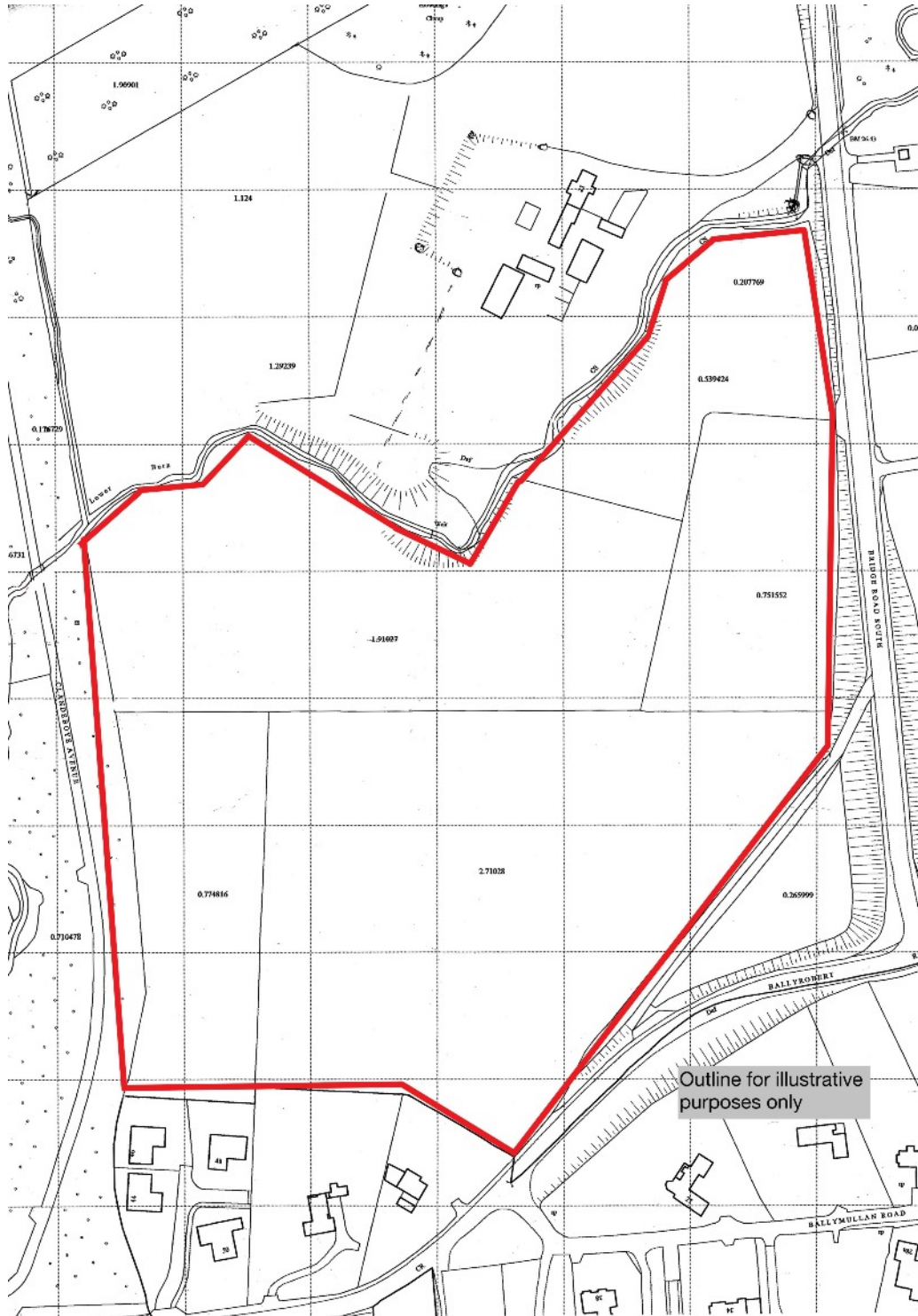

These particulars do not constitute any part of an offer or contract. None of the statements contained in these particulars are to be relied on as statements or representations of fact and intending purchasers must satisfy themselves by inspection or otherwise to the correctness of each of the statements contained in these particulars. The Vendor does not make or give, neither Templeton Robinson, nor any person in its employment has any authority to make or give, any representation or warranty whatever in relation to this property. All dimensions are taken to nearest 3 inches.